

SCALE: 1" = 60'0"

U.S. ROUTE 6 & 24 BYPASS

- GENERAL NOTES**
1. CONTRACTORS SHALL FIELD-VERIFY ALL EXISTING ELEVATIONS OF CURBS, PAVEMENT, CATCH BASINS, MANHOLES, RAMPS & UTILITY LOCATIONS PRIOR TO BIDDING & BEGINNING WORK. IN THE EVENT OF CONFLICTS, CONTRACTOR SHALL SEEK RESOLUTION FROM ARCHITECT OR COUNTY ENGINEER PRIOR TO BEGINNING WORK.
 2. CONTRACTOR SHALL BE RESPONSIBLE FOR THE PROTECTION OF SURROUNDING ADJACENT SURFACES AND/OR MATERIALS DURING DEMOLITION.
 3. G.C. SHALL PATCH/REPAIR ANY EXISTING CURBS, CONCRETE, ASPHALT PAVEMENT, ETC. TO REMAIN, WHICH ARE DAMAGED DURING DEMOLITION AND/OR CONSTRUCTION, TO MATCH EXISTING ADJACENT SURFACE MATERIALS.
 4. STANDARD & HANDICAP ACCESSIBLE SPACES ARE TO BE 9' WIDE. VAN-ACCESSIBLE HANDICAP SPACES ARE TO BE 11' WIDE. ACCESS AISLES FOR ALL HANDICAP SPACES ARE TO BE 5' WIDE MINIMUM.
 5. HANDICAP ACCESSIBLE PARKING SPACES, ACCESS AISLES, AND CORRESPONDING SIGNAGE MUST CONFORM TO ADA STANDARDS. (SIGNS TO BE INSTALLED BY COUNTY FORCES.)

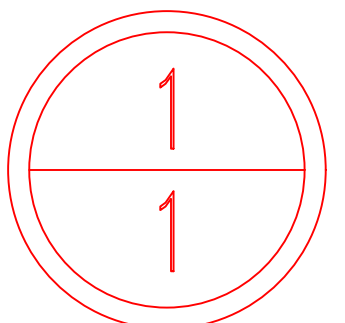

REMOVE (2) ISLANDS (LIGHT POLES TO REMAIN); CONSTRUCT GREENSPACE (SEE DETAILS)

*NOTE: GREEN PHANTOM LINES DEPICT PAVING LIMITS

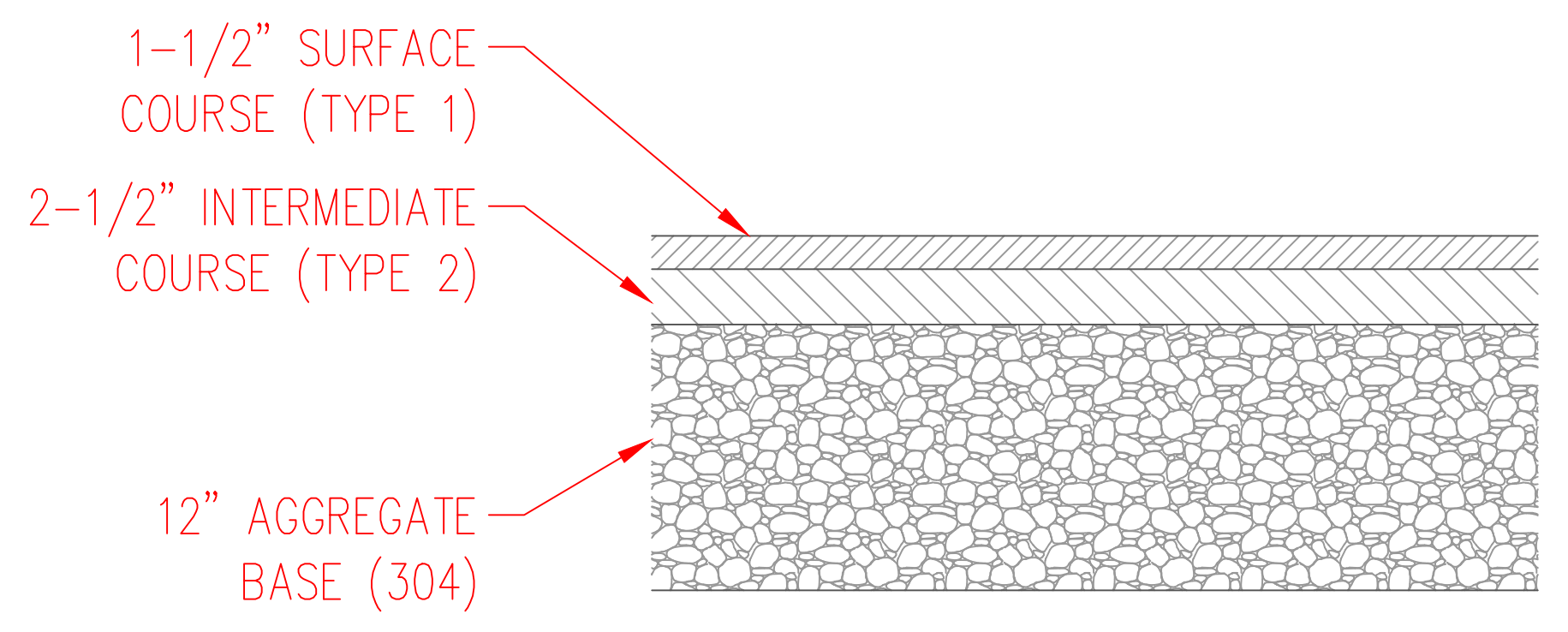
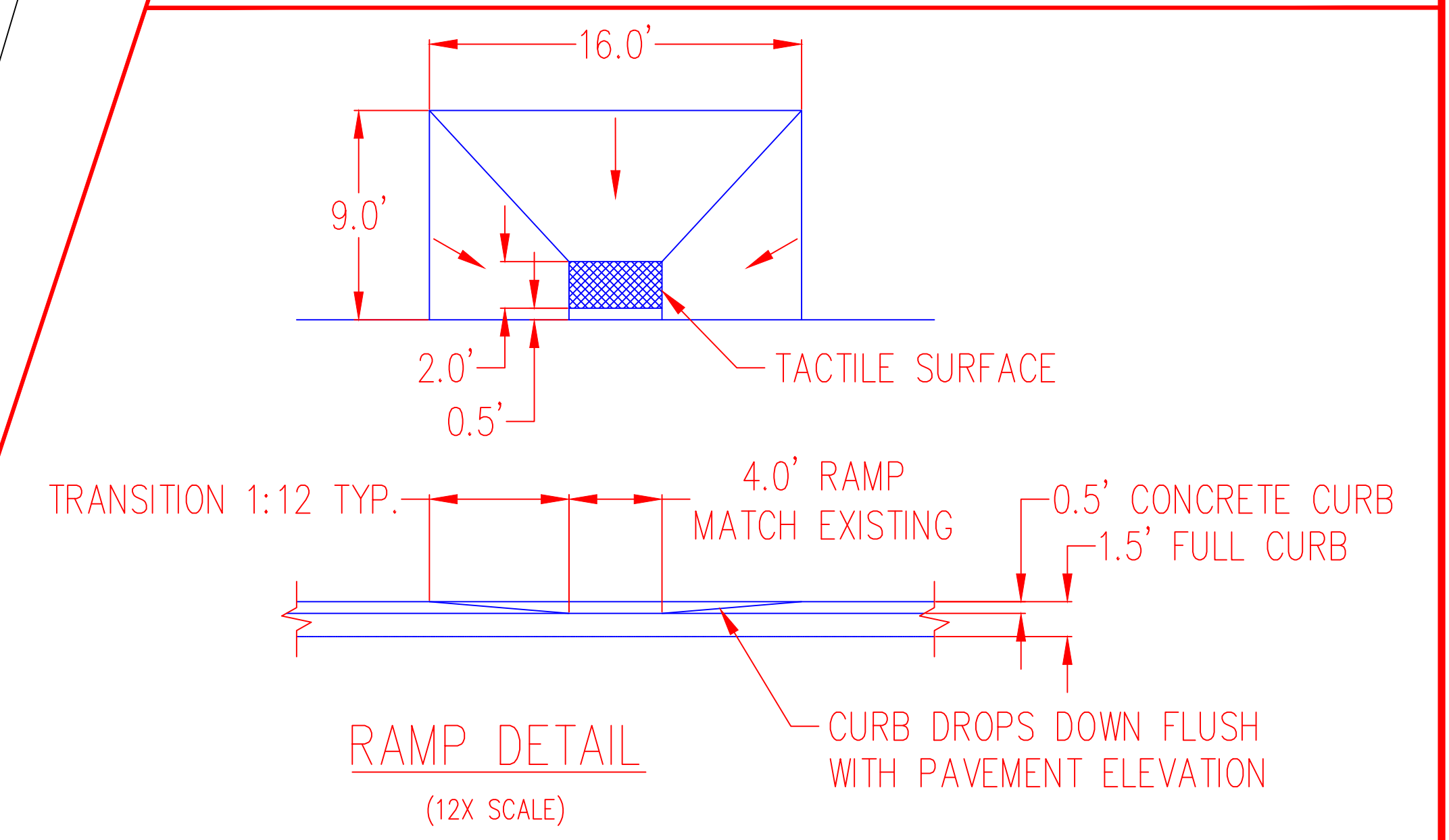
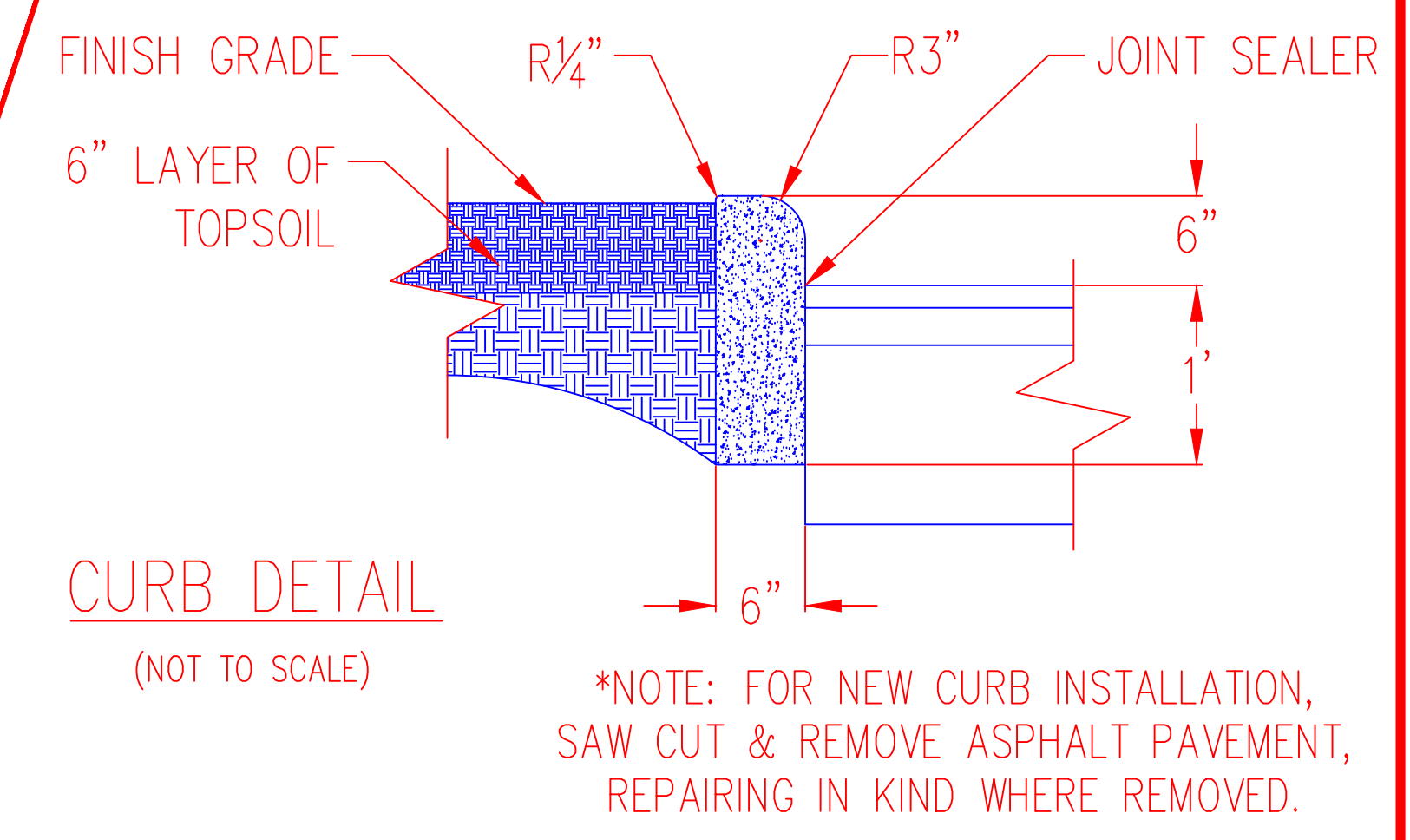
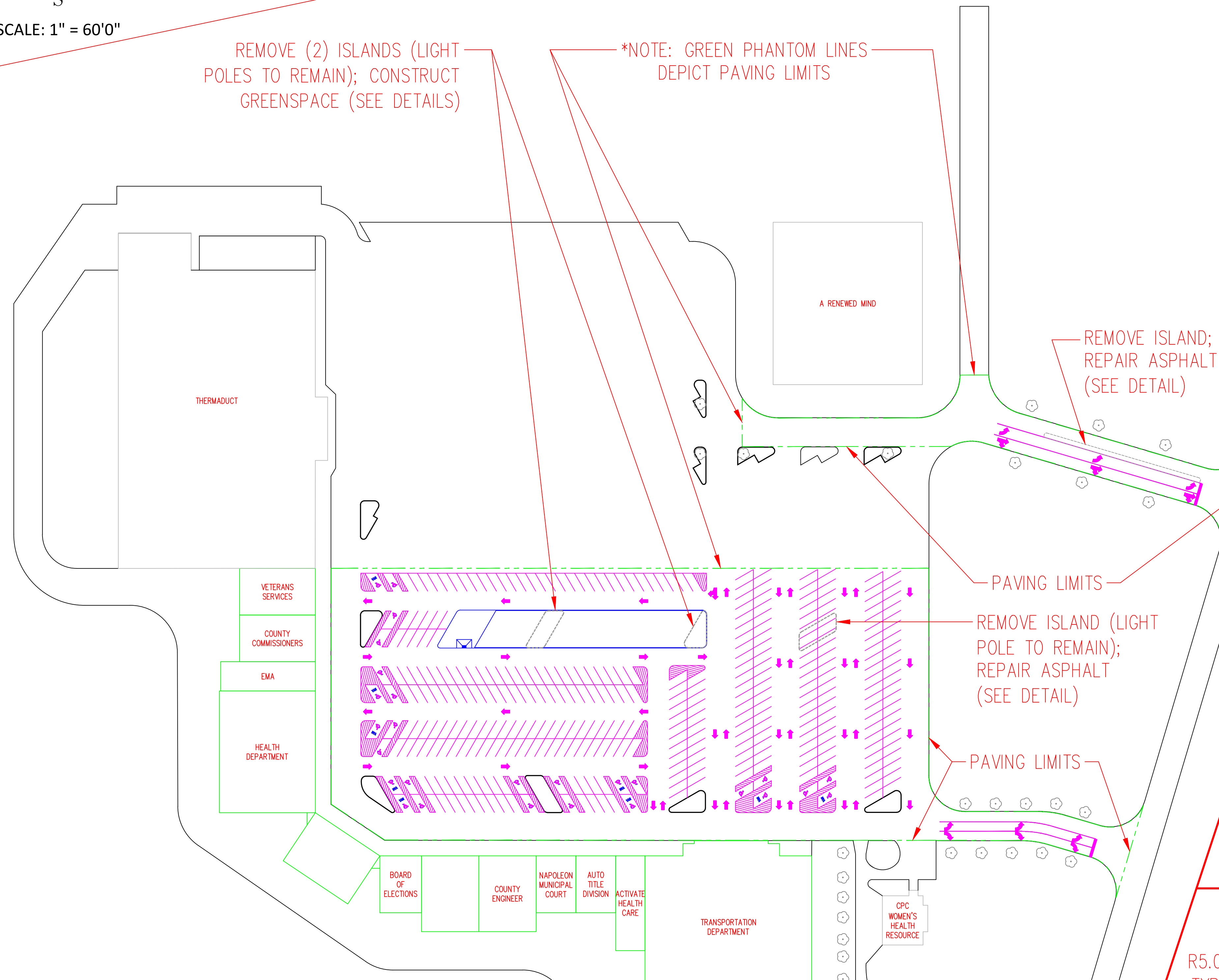

TOTAL PARKING SPACES:
STANDARD - 316
HANDICAP ACCESSIBLE - 18
VAN-ACCESSIBLE HC - 9

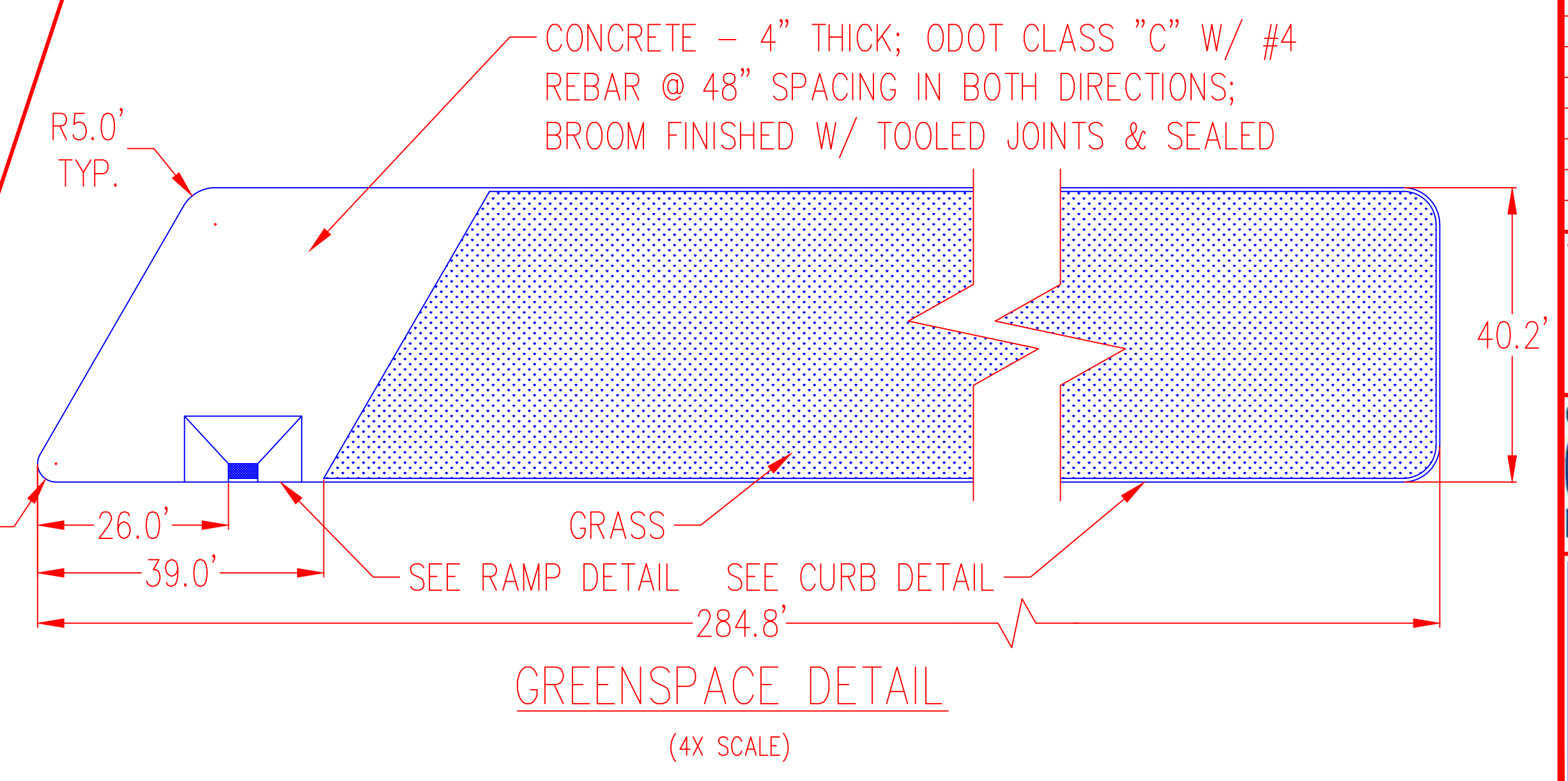

HENRY COUNTY - OAKWOOD PLAZA
PARKING LOT PROJECT SITE PLAN

DRAWING DETAILS

DRAWN BY:	JTH 01/12/24
DESIGNED BY:	JTH 01/09/24
REVIEWED BY:	TJS 01/16/24
REVISED	
JTH 01/30/24	
JTH 02/06/24	

TIMOTHY J. SCHUMM, P.E., P.S.
HENRY COUNTY ENGINEER
1823 OAKWOOD AVENUE
NAPOLEON, OHIO 43545
419-592-2976

